

Features

- Ultra-portable camping light
- Two available colour temperature options
- LA10: Utilises a CREE XP-G2 S3 LED
- LA10 CRI: Utilises a Nichia 219B LED, CRI≥90
- Powered by a single AA sized battery
- Maximum runtime up to 23 hours
- 3 Brightness levels and 1 special mode available
- High-efficiency regulation circuit provides unwavering output
- Reverse polarity protection
- Magnetic tail cap with tail stand capability
- IPX6 rated
- Impact resistant to 1.5 meter

Dimensions

Length: 3.08"(78.5mm)
Tube diameter: 0.89" (22.6mm)
Weight: 1.51oz(42.7g)(without battery)

Accessories

Lanyard, O-ring

Battery Options

| | SIZE | Nominal voltage | Compatible |
|----------------------------|------|-----------------|-----------------|
| Primary AA battery | AA | 1.5V | Y (Recommended) |
| Rechargeable AA battery | AA | 1.2V | Y (Recommended) |
| Primary AA Lithium battery | L91 | 1.5V | Y |

Output & Runtime

| LA10 | | | | LA10 CRI | | | |
|--------------|-------------------------|-----------|-----------|--------------|-------------------------|-----------|----------|
| FL1 STANDARD | HIGH | MID | LOW | FL1 STANDARD | HIGH | MID | LOW |
| | 135 LUMENS | 40 LUMENS | 10 LUMENS | | 85 LUMENS | 30 LUMENS | 9 LUMENS |
| | 1h30min | 6h | 23h | | 1h30min | 6h | 23h |
| | 10m(Beam Diameter) | | | | 10m(Beam Diameter) | | |
| | 1.5m (Impact Resistant) | | | | 1.5m (Impact Resistant) | | |
| | IPX6(Rated) | | | | IPX6(Rated) | | |

NOTICE: The above data has been measured in accordance with the international flashlight testing standards ANSI/NEMA FL1 using 1x AA (1.2V, 2450mAh) battery under laboratory conditions. The data may vary slightly during real-world use due to battery type, individual usage habits and environmental factors.

Operating Instructions

Battery installation

Insert one AA battery with the + polarity pointing towards the head, as illustrated in the diagram below:

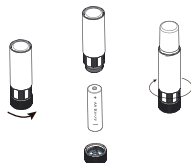

Power ON/OFF

Tighten the tail cap to turn the light on, loosen the tail cap to turn the light off.

Note: The LA10/LA10 CRI's light bar has lipstick-like extensile and retractile movement through the open tube end. The bar can be moved by rotating the base of the light in clockwise and anti-clockwise motion.

Brightness adjustment

Turning the LA10/LA10 CRI on within a 2 second interval after it is turned off will switch the light to the next available mode, repeat this process to cycle through "low-mid-high-beacon".

Note: The LA10/LA10 CRI does not have memory function, it will always turn on at the low output after it has been turned off for more than 2 second.

Changing battery

Change battery when output becomes dim or unresponsive.

Maintenance

Wipe the threads every 6 months with clean cloth followed by a thin coating of silicon-base lubricant.

Precautions

1. Do NOT install batteries backward, it renders the light inoperative.
2. Always use quality batteries, remove batteries from the battery compartment when the light will be left unattended for extensive period.
3. Avoid direct eye exposure
4. Packaging contains small assembly parts, keep away from children to avoid danger of suffocation.
5. Do NOT disassemble or modify the product.

Warranty Details

Our authorized dealers and distributors are responsible for warranty service. Should any problem covered under warranty occurs, customers can contact their dealers or distributors in regards to their warranty claims, as long as the product was purchased from an authorized dealer or distributor. NITECORE's Warranty is provided only for products purchased from an authorized source. This applies to all NITECORE products.

Any DOA / defective product can be exchanged for a replacement through a local distributor/dealer within the 15 days of purchase. After 15 days, all defective / malfunctioning NITECORE® products can be repaired free of charge for a period of 60 months (5 years) from the date of purchase. Beyond 60 months (5 years), a limited warranty applies, covering the cost of labor and maintenance, but not the cost of accessories or replacement parts. The warranty is nullified if the product(s) is/are broken down, reconstructed and/or modified by unauthorized parties, or damaged by batteries leakage. For the latest information on NITECORE® products and services, please contact a local NITECORE® distributor or send an email to service@nitecore.com.

※All images, text and statements specified herein this user manual are for reference purpose only. Should any discrepancy occurs between this manual and information specified on www.nitecore.com. Sysmax Industry Co., Ltd. reserves the rights to interpret and amend the content of this document at any time without prior notice.

SYSMAX Ind.

SYSMAX Industry Co., Ltd.

TEL: +86-20-83862000

FAX: +86-20-83882723

E-mail: info@nitecore.com

Web: www.nitecore.com

Address: Rm1401-03, Glorious Tower, 850 East Dongfeng Road, Guangzhou, China 510600

Please find us on facebook:
NITECORE Flashlights

